

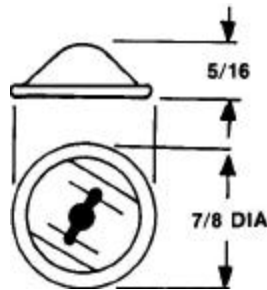

WASHERS, CAPS & NUTS

MISCELLANEOUS INSULATION WASHERS



Capped Speed Washer

APPLICATION: Designed to permanently lock on 12 GA weldpin© or insul-anchors where appearance is a major factor, or where no sharp points or edges are permissible on the surface.

MATERIAL: Decorative Domed Cap - Aluminum Self-Locking Insert - Hardened Steel

COLORS: Plain or painted white.

TO ORDER OR SPECIFY GIVE.

1. Size 12 GA
2. Color

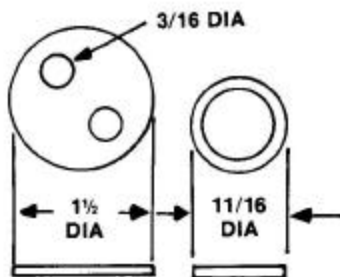

Lacing Washer & Ring

APPLICATION Designed to be used with lacing wire to wrap insulation around irregular shapes.

MATERIAL: Washer - Aluminum or Stainless Steel Ring - Zinc alloy, bright zinc plated.

NO - AB: Washers are available stamped NO AB to indicate nonasbestos material.

TO ORDER OR SPECIFY GIVE:

1. Product Code Lacing Washer or Lacing Ring
2. Material (Washer)

**All information contained herein is subject to change without notice.
For more information-consult your nearby Continental Field sales representative.**